



USER MANUAL

RECHARGEABLE LED SPOT LIGHT

WORKZONE®



AFTER-SALES SUPPORT

850322 

AU



1800 898 750



service@wkfe.com.hk

MODEL: 1313-B, 1313-G

08/2025

1

YEAR WARRANTY

1 GENERAL INFORMATION

1.1 READING AND STORING THE USER MANUAL



This user manual belongs to this rechargeable LED spot light, hereinafter also referred to as the product. It contains important information on how to set up and use the product.

Read the user manual carefully, in particular the safety instructions, before using the product. Failure to follow this user manual may lead to severe injuries or product damage.

Keep this user manual for future reference. If you pass this product on to a third party, you must also supply this user manual.

You can also obtain these operating instructions from our website <https://www.wachsmuth-krogmann.com>

2 SAFETY

The following signal words are used in this user manual.

WARNING!

This signal symbol/word denotes a hazard with an average risk level that could lead to death or severe injury if it is not avoided.

CAUTION!

This signal symbol/word denotes a hazard with a low risk level that could lead to mild or moderate injury if it is not avoided.

CAUTION!

This signal word provides a warning about potential material damage.

NOTICE

This symbol provides you with useful additional information on handling and use.

2.1 EXPLANATION OF SYMBOLS

The following symbols are used in this user manual, on the product or on the packaging.



The RCM Mark (Regulatory Compliance Mark) indicates that the product complies with the relevant guidelines of the ACMA as well as corresponding government requirements for the safety of electrical devices.



The product meets the specifications of protection class III and is operated with safety extra-low voltage.

IP44

The product is protected against penetrating foreign objects with a diameter of ≥ 1 mm and it is splashproof from all directions.

2.2 SAFETY NOTES

WARNING!

Risk of electric shock!

Faulty electric installation or excess voltage can cause an electric shock.

- » Only connect the power cable if the voltage of the voltage source matches the information shown on the rating plate.
- » The product must only be operated with extra low voltage (in line with the class III marking on the product).

WARNING!

Danger to children and persons with reduced physical, sensory or mental abilities (e.g. partially disabled, elderly people with reduced physical and mental abilities) or lack of experience and knowledge (e.g. older children).

- » This product can be used by children aged from 8 years and above and persons with reduced physical, sensory or mental capabilities, or lack of experience and knowledge if they have been given supervision or instruction concerning use of the product in a safe way and understand the hazards involved.
- » Keep children under 8 away from the product and the power cable.
- » Do not leave the product unattended when in use.
- » Children may not play with the product.
- » Do not let children play with the packaging film. They may become tangled when playing and suffocate.
- » Children must not clean or service the device unsupervised.

CAUTION!

Risk of injury!

The light of the LEDs is very bright and can damage your eyes when looking directly at them.

- » Do not look directly into the light of the LEDs.
- » Do not look at the LEDs with an optical instrument while the product is in operation.

CAUTION!

Risk of damage!

Improper assembly can damage the product.

- » Charge the product once the light output decreases to prevent the battery from suffering a deep discharge.
- » Operate the product on an easily accessible, level, dry, heat resistant and sufficiently stable work surface. Never place the product on the edge of the work surface.
- » Never place the product on or near hot surfaces (stove tops, etc.) and never expose the product to high temperatures (heaters, etc.) or to bad weather (rain, etc.).
- » Never immerse the product in water to clean it, and do not use a steam cleaner. This can damage the product.
- » Stop using the product if any of its components are cracked or deformed. Only replace damaged components with matching original spare parts.
- » Do not attempt to repair or modify the product yourself. Have repairs carried out by trained personnel.

2.3 SAFETY NOTES FOR BATTERIES

CAUTION!

Risk of explosion!

- » Never short-circuit the battery.
- » Never open the battery.
- » Do not throw the battery into a fire.
- » Only charge the product via the supplied USB cable on a suitable USB charger or via the USB port on a computer.
- » Charge the battery at room temperature.
- » This product contains batteries that cannot be replaced. Correctly dispose of the product once the battery has reached the end of its service life.

CAUTION!

Risk of chemical burns!

- » Never open the battery.
- » If battery fluid leaks out, avoid contact with the skin, eyes and mucus membranes. Rinse the affected region immediately with plenty of clear water and contact a physician immediately.
- » Wear protective gloves in case of a leaky battery.

NOTICE

- » If the battery is defective, the complete product must be disposed of correctly.

2.4 PROPER USE

The product is exclusively intended for lighting indoor and outdoor workspaces. The product is not suitable as a reading light.

It is only intended for private indoor use and not suitable for commercial purposes.

Only use the product as described in this user manual. Any other use is considered improper and may result in damage to property or persons. The product is not a children's toy.

The manufacturer or vendor cannot be held liable for damages or injury incurred through improper or incorrect use.

3 PRODUCT OVERVIEW

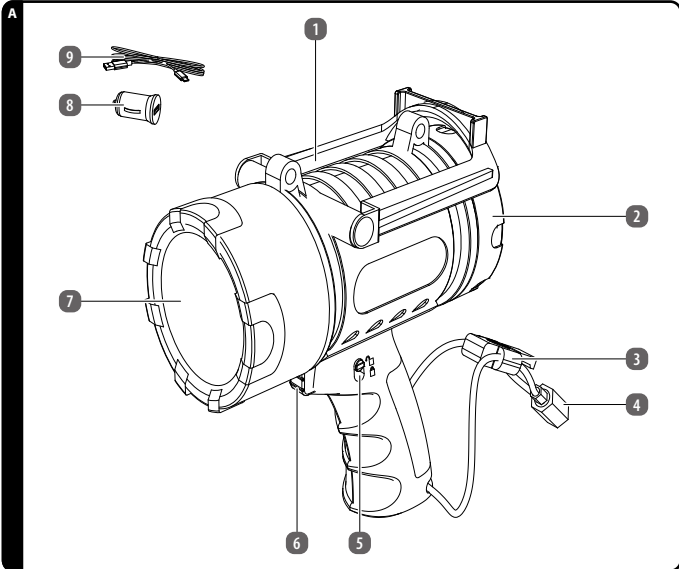

1 Handle

2 Cover

3 Whistle

4 Hand strap

5 Lock

6 On/off switch

7 LED

8 Car adapter (inside product)

9 USB connection cable (inside product)

4 BEFORE FIRST USE

4.1 CHECK THE PRODUCT AND SCOPE OF DELIVERY

CAUTION!

Risk of damage!

If opening the packaging with a sharp knife or other pointed object, be careful to avoid damaging the product's surface.

- » Proceed carefully with opening the packaging.

1. Take the product out of the packaging.
2. Check that the delivery is complete (see chapter ^{***}).
3. Inspect the product and individual parts for damage. Do not operate a damaged product, instead, contact the manufacturer via the service center listed on the warranty card.

4.2 CHARGING THE PRODUCT

CAUTION!

Risk of damage!

Charging the car battery with a charger can damage the product.

- » Switch off the product and disconnect the vehicle connection cable from the cigarette lighter socket before charging your vehicle battery with a charger.

CAUTION!

The vehicle battery is under load!

When operating on a cigarette lighter socket, the capacity of the vehicle battery may be impaired and the vehicle may no longer start.

- » Do not use the product if your vehicle battery is low.
- » Only use the product for short periods when the vehicle engine is switched off.
- » If necessary, equip your vehicle with voltage protection or an additional battery.

Fully charge the battery before using the product for the first time. Only use the USB connection cable **9** located behind the cover **2** and / or the car adapter **8**. Only charge the product in dry indoor areas or in a car.

NOTE

- » The product cannot be switched on during the charging process, so continuous operation is not possible.

B

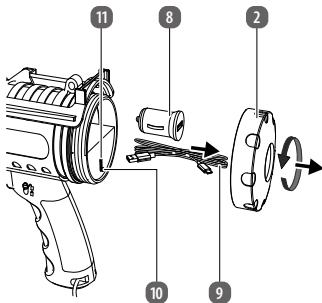

1. Unscrew the cover (2) anti-clockwise.
2. Remove the required accessories.
3. Connect the USB connection cable (9) to the USB port (11).
4. Connect the USB connection cable
 - to the USB connection of a power supply unit or
 - to the USB port of the car adapter, after plugging the car adapter into cigarette lighter socket with 12 V DC voltage.
The charging indicator (10) lights up red. The charging indicator lights up green as soon as the product is fully charged.
5. Disconnect the USB connection cable from the USB port of the product and the power supply unit / car adapter.
6. Proceed in reverse order to assemble it.

5 OPERATION

5.1 SWITCHING THE LIGHT ON/OFF AND CHANGING SETTINGS

1. Press the on/off switch (6).
The LED (7) lights up.
2. Release the on/off switch.
The LED is switched off.

The following light modes can be set by pressing the on/off switch several times:

Pressing the button	1	LED lights up (100%)
	2	LED lights up (50%)
	3	SOS
	4	OFF

5.2 TRANSPORT LOCK

1. Slide the lock (5) downwards to secure the product against unintentional switching on.
The transport lock is activated.
2. Slide the lock upwards to deactivate the transport lock.

5.3 USE HAND STRAP AND WHISTLE

- Guide the hand strap (4) over your wrist.
The product can now be used and worn safely and comfortably.
- Blow into the whistle (3).
This allows you to draw attention to yourself in emergency situations.

5.4 USING THE HANDLE

NOTE

- » Do not use the handle as a stand.

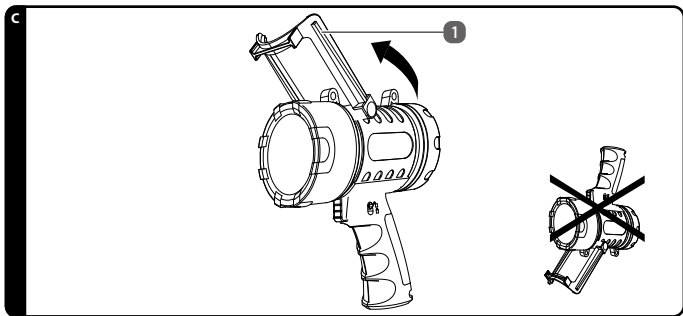

Fold out the handle (1).

You can carry the product by the handle.

6 CLEANING

CAUTION!

Risk of damage!

Improper handling can damage the product.

- » Do not use any harsh cleaning products, brushes with metal or nylon bristles, or sharp or metallic cleaning materials such as knives, hard scrapers or similar. They may damage the surfaces.

6.1 CLEANING THE DEVICE

Wipe the surfaces down with a dry cloth.

7 INSPECTION

Before each use check that:

- the product is undamaged,
- the controls are not damaged,
- the accessories are in perfect condition.

Do not operate a damaged product or accessory. Instead, have it inspected and repaired by the manufacturer or their customer service or a similarly qualified person.

8 STORAGE

CAUTION!

Risk of damage!

Improper storage of the product can result in damage.

- » Store the product in a clean, dry, frost-protected place out of the reach of children.

All parts must be completely dry before they are put away.

- Always store the product in a dry place.
 - Protect the product from direct sunlight.
 - Store the product out of the reach of children, safely closed, at a storage temperature between +5 °C and +20 °C (room temperature).
1. Thoroughly clean the product (see section "Cleaning").
 2. Roll up the USB cable without knots or bends.

9 TROUBLESHOOTING

PROBLEM	POSSIBLE CAUSE	REMEDY
Decreasing light output.	Low battery. The battery is empty.	Charge the product (see section "Charging the product"). Charge the product (see section "Charging the product").
Product not working.	The battery is defective. The illuminant is defective.	Dispose of the product.

10 TECHNICAL DATA

Item number::	850322
Model number:	1313-B, 1313-G
Battery type:	Li-ion, 18650, 3.7 V 2,200 mAh
Supply voltage:	Input (USB): 5 V  / 1 A
Protection class:	
USB connection cable:	Type USB-A to USB-C

Charging time:	4.5 - 5.5 hours
LED type:	1 x 5 W LED
LED colour:	5000 - 6500 K (\pm 500 K)
Brightness:	100%: approx. 600 lm (\pm 10%), 50%: approx. 300 lm (\pm 10%) max. 3.5 hours (50% brightness)
On time:	300 m
Light range max:	approx. 14.65 x 7.76 x 16.8 cm
Dimensions:	approx. 311 g/ 0.68 lb
Weight:	IP44
IP rating:	

Cigarette lighter socket:

Input voltage:	12-24 V 
Fuse:	Patch safety resistor (non replaceable by the consumer)

The light source of this lamp must exclusively be replaced by the manufacturer, a service engineer commissioned by the manufacturer or persons with equivalent qualifications.

11 DISPOSAL

11.1 DISPOSING OF PACKAGING



Dispose of packaging according to type. Sort the paperboard and cardboard as waste paper and the film as recyclable material.

11.2 DISPOSE OF OLD ELECTRICAL DEVICE



Old electrical products may not be disposed of as household waste!

If the product cannot be used anymore, each consumer **is obligated by law to dispose of old products separately from household waste**, e.g. at a municipal/city district collection point. It is thereby ensured that old products are professionally recycled and negative effects on the environment are avoided. Therefore, electrical products are marked with the above symbol.

The product contains a battery that cannot be removed by end customers. Contact a specialist for correct disposal.



The symbol opposite means that batteries and accumulators must not be disposed of with household waste. Consumers are legally obliged to dispose of batteries and rechargeable batteries separately.

Batteries and rechargeable batteries can be returned free of charge to a collection point in your municipality/borough or to a retailer so that they can be disposed of in an environmentally friendly manner and valuable raw materials can be recovered. Improper disposal can result in toxic substances being released into the environment, which can have harmful

effects on humans, animals and plants.

Batteries and rechargeable batteries contained in electrical appliances must be disposed of separately if possible. Only dispose of batteries and rechargeable batteries when they are discharged.

If possible, use rechargeable batteries instead of disposable batteries.

Before disposing of lithium-containing batteries and rechargeable batteries, tape off the terminals to prevent an external short circuit. A short circuit can lead to a fire or explosion.

Batteries with increased pollutant content are also marked with the following symbols: Cd = Cadmium, Hg = Mercury, Pb = Lead, Li = Lithium

12 WARRANTY

12.1 WARRANTY CERTIFICATE

REGISTER YOUR PURCHASE AT www.aldi.com.au/en/about-aldi/product-registration TO KEEP UP-TO-DATE WITH IMPORTANT PRODUCT INFORMATION

Congratulations! You have made an excellent choice of this quality product. Our commitment to quality also includes our service. Should you, contrary to expectations, experience defects due to manufacturing faults, ALDI will provide you with a warranty against defects as follows:

The product is guaranteed to be free from defects in workmanship and parts for a period of 1 year (dependant on product) from the date of purchase. Defects that occur within this warranty period, under normal use and care, will be repaired, replaced or refunded at our discretion.

The benefits conferred by this warranty are in addition to all rights and remedies in respect of the product that the consumer has under the Competition and Consumer Act 2010 and similar state and territory laws. Our goods come with guarantees that cannot be excluded under the Australian Consumer Law. You are entitled to a replacement or refund for a major failure and for compensation for any other reasonably foreseeable loss or damage. You are also entitled to have the goods repaired or replaced if the goods fail to be of acceptable quality and the failure does not amount to a major failure.

12.2 PROOF OF PURCHASE

This warranty is valid for the original purchase and is not transferable. Please keep your purchase docket, tax invoice or receipt as the best proof of purchase, and as proof of date on which the purchase was made.

12.3 EXTENT OF WARRANTY

This warranty is limited to defects in workmanship or parts. All defective products or parts will be repaired or replaced. This warranty does not cover batteries or any other consumable items.

12.4 NORMAL WEAR AND TEAR

This warranty does not cover normal wear and tear to the products or parts.

12.5 EXCLUSIONS

This warranty does not cover:

- Any defects caused by an accident, misuse, abuse, improper installation or operation, lack of reasonable care, unauthorised modification, loss of parts, tampering or attempted repair by a person not authorised by the distributor.
- Any product that has not been installed, operated or maintained in accordance with the manufacturer's operating instructions provided with the product.
- Any product that has been used for purposes other than domestic use.
- Any damage caused by improper power input or improper cable connection.

12.6 TO MAKE A CLAIM

This warranty against defects is provided by:

ALDI Stores, Locked Bag 56, St Marys Delivery Centre, NSW 2760, Phone (02) 9675 9000.

If a defect in the goods appears within 1 year (the identified period on the packaging), you are entitled to claim a warranty, please contact or send all warranty claims to:

Install + Fix Solutions

Unit 1, 9 Kingsbury Street, Brendale, QLD 4500, AUSTRALIA

1800 898 750 Monday to Thursday, 8am-4pm

service@wkfe.com.hk

When making a return, please ensure the product is properly packaged so as to ensure that no damage occurs to the product during transit. Please provide the original or a copy of the proof of purchase. Also please make sure you have included an explanation of the problem. Please note that the costs of making a warranty claim, including any return postage, will be covered by the supplier identified above. Please note upon receiving your warranty claim, the supplier will send, via the post or email, a repair and refurbished goods or parts notice. Please provide your email address and advise the supplier, if you wish to obtain a repair and refurbished goods or parts notice via email.

12.7 WARRANTY DETAILS

The product is guaranteed to be free from defects in workmanship and parts for a period of 1 year from the date of purchase. Defects that occur within this warranty period, under normal use and care, will be repaired, replaced or refunded at our discretion. The benefits conferred by this warranty are in addition to all rights and remedies in respect of the product that the consumer has under the Competition and Consumer Act 2010 and similar state and territory laws.

Our goods come with guarantees that cannot be excluded under the Australian Consumer Law. You are entitled to a replacement or refund for a major failure and for compensation for any other reasonably foreseeable loss or damage. You are also entitled to have the goods repaired or replaced if the goods fail to be of acceptable quality and the failure does not amount to a major failure.

12.8 REPAIR AND REFURBISHED GOODS OR PARTS NOTICE

Unfortunately, from time to time, faulty products are manufactured which need to be returned to the Supplier for repair.

Please be aware that if your product is capable of retaining user-generated data (such as files stored on a computer hard drive, telephone numbers stored on a mobile telephone, songs stored on a portable media player, games saved on a games console or files stored on a USB memory stick) during the process of repair, some or all of your stored data may be lost.

We recommend you save this data elsewhere prior to sending the product for repair.

You should also be aware that rather than repairing goods, we may replace them with refurbished goods of the same type or use refurbished parts in the repair process.

Please be assured though, refurbished parts or replacements are only used where they meet ALDI's stringent quality specifications.

If at any time you feel your repair is being handled unsatisfactorily, you may escalate your complaint. Please telephone us on 1800 898 750 or write to us at:

Install + Fix Solutions

Unit 1, 9 Kingsbury Street, Brendale, QLD 4500, AUSTRALIA

1800 898 750 Monday to Thursday, 8am-4pm

service@wkfe.com.hk



ALDI guarantees that our exclusive brand products are developed to our stringent quality specifications. If you are not entirely satisfied with this product, please return it to the nearest ALDI store within 60 days from the date of purchase, for a full refund or replacement, or take advantage of our after sales support by calling the supplier's Customer Service Hotline.

WORKZONE® is a registered trademark of ALDI Stores

DISTRIBUTED BY

ALDI STORES

1 SARGENTS ROAD

MINCHINBURY NSW 2770

WWW.ALDI.COM.AU

Made in China

V02/0425